

Park

K Recommended:
Kindergarten

 Length:
45-55 minutes

About this lesson

At this location, students learn about occupations in the **Helping** career path, including volunteer work. Students also learn about being responsible community members and the importance of keeping parks and natural areas clean.

Learning objectives

By the end of this lesson, students will understand the importance of being responsible community members and keeping parks and natural areas clean.

Discussion prompts

- Why are parks important in our community?
- Why is it important to keep parks clean?
- What is the difference between recycling something and throwing it in the trash?
- Who are volunteers?
- What are some other **Helping** jobs you can think of?

Occupations and characters

- Nuttah - Volunteer
- Officer Jan - Police Officer
- Mayor Josh - Mayor

Lesson breakdown

10-15
minutes

Activity 1 - Discussion

Class brainstorm: Display the discussion questions for students. Allow them a few minutes to consider the questions independently, then ask for volunteers or choose a few students to share their responses. After each student shares, ask the class to respond (thumbs up/down, nod/shake head) to the response (do they agree/disagree? Does this answer make them think differently about their own answers? Ask for volunteers to expand).

Optional: Students may answer questions in a quick write, if applicable.

15-20
minutes

Activity 2 - Career Town location: Park

The first time students visit this location, they are asked to help sort out some chaos caused by a missing worker. After completing a 3-minute mini-game, students receive a report of another missing worker. Information about the missing workers is stored as a case file in the **People** section of students' **Dpads**. The character then presents students with a clue left behind by Ernestine - a note! Before moving on to a new location, Detective Jill quizzes students about the workers at the location and their occupations. After completing the quiz, students are rewarded with a badge, which is kept in the **Badges** app of their **Dpad**.

Xello entry point

Clean up!: In this game, students help clean up the Park.

To play: Students place garbage and recyclables in the proper containers, water the grass, rake leaves, and remind litterbugs not to throw trash on the ground.

Vocabulary

- Responsible
- Nature
- Recycle
- Litter
- Restore
- Patrol

Student handouts

Click the link below to open the handout in Google Docs. Click **File** and **Make a copy** to save it to your own Google Drive. Now you can make your changes to the handout before sharing with students! Or, under **File**, click **Download** so you can begin sharing the PDF, as is.

[Copy student handout](#)

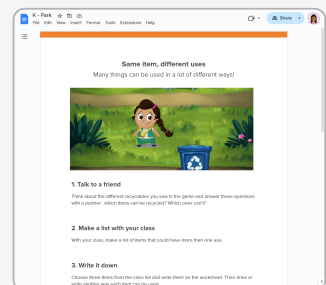

Park



Recommended:
Kindergarten



Length:
45-55 minutes

15-20
minutes

Activity 3 - Same item, different uses

Have students talk with a partner about which recyclable items they saw in the **Park** location. Brainstorm a list of items that could have more than one use as a class. Then, have students write the items on the left side of the chart on the worksheet, and either write or draw another use for that item on the right.